

10

**ARTICOLI VARI**  
**VARIOUS ITEMS**

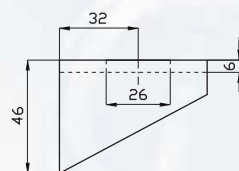

COD. 04.033

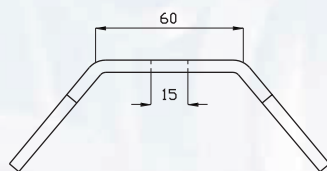
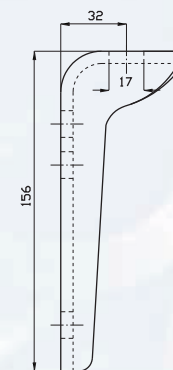
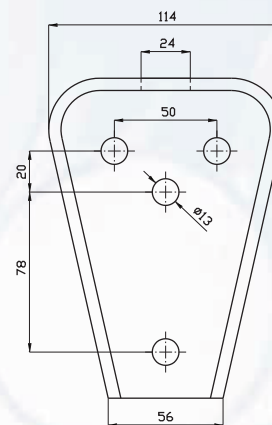

COD. 303.112

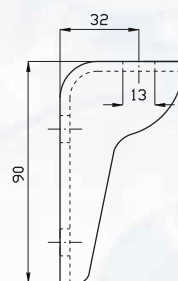
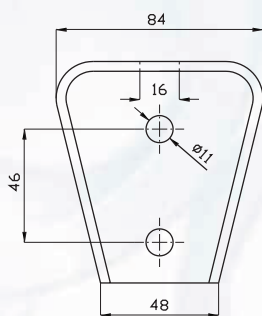

COD. 04.007

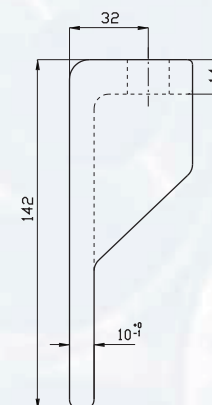
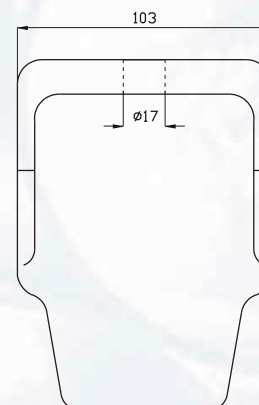

COD. 04.664  
COD. 04.018

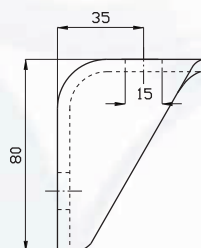
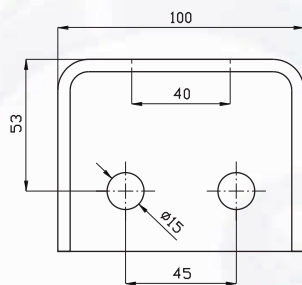

COD. 303.111

Supporto telaio leggerissimo		
<i>Extra light frame support</i>		
<b>COD.</b>	04.033	<b>KG.</b> 0,35

Supporto telaio leggero		
<i>Light frame support</i>		
<b>COD.</b>	04.007	<b>KG.</b> 0,36

Supporto telaio medio		
<i>Medium frame support</i>		
<b>COD.</b>	303.111	<b>KG.</b> 0,55

Supporto telaio pesante		
<i>Heavy frame support</i>		
<b>COD.</b>	303.112	<b>KG.</b> 0,95

Ciabatta falso telaio stampata		
<i>Pressed frame support</i>		
<b>COD.</b>	04.664	<b>KG.</b> 1,6

Ciabatta falso telaio stampata forata		
<i>Drilled pressed frame support</i>		
<b>COD.</b>	04.018	<b>KG.</b> 1,6

Innesto piantone tipo F			
<i>Male part F type for coupling</i>			
<b>COD.</b>	13.013	<b>KG.</b>	1,36

Sede innesto piantone tipo F			
<i>Seating F type for coupling</i>			
<b>COD.</b>	13.014	<b>KG.</b>	0,36

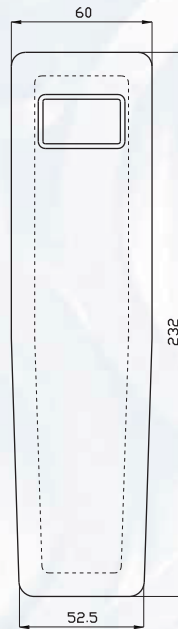

COD. 13.013

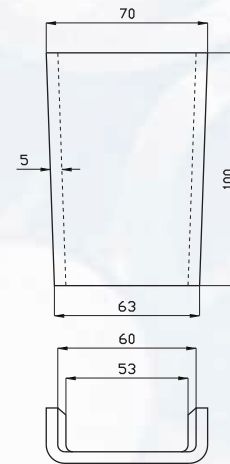

COD. 13.014

Innesto per piantone grezzo			
<i>Rough male part for coupling</i>			
<b>COD.</b>	13.036	<b>KG.</b>	3,5
Innesto per piantone inox grezzo			
<i>Inox rough male part for coupling</i>			
<b>COD.</b>	13.037	<b>KG.</b>	3,5

Scatola bassa grezza			
<i>Rough short seating for coupling</i>			
<b>COD.</b>	13.008	<b>KG.</b>	1,8
Scatola bassa inox grezza			
<i>Inox rough short seating for coupling</i>			
<b>COD.</b>	13.019	<b>KG.</b>	1,8
Scatola alta grezza			
<i>Rough tall seating for coupling</i>			
<b>COD.</b>	13.009	<b>KG.</b>	2,5

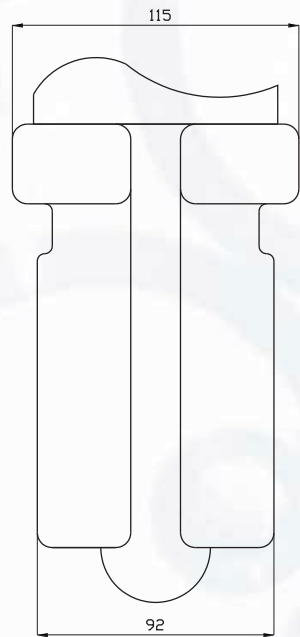

COD. 13.036  
COD. 13.037

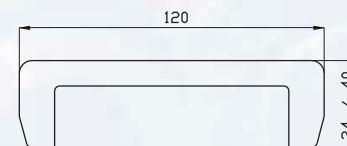
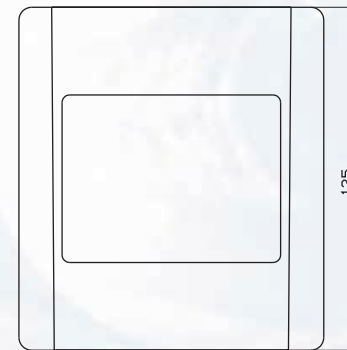

COD. 13.008  
COD. 13.019  
COD. 13.009

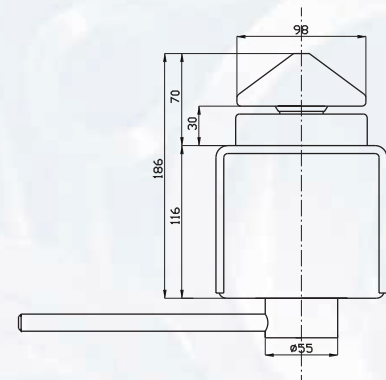

COD. 303.123

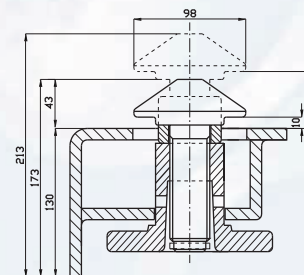
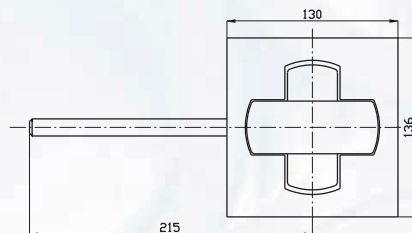

COD. 202.132

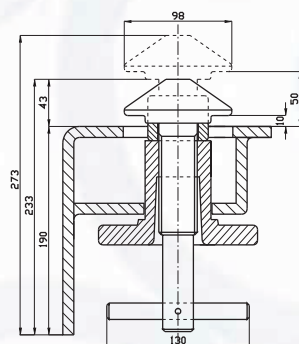
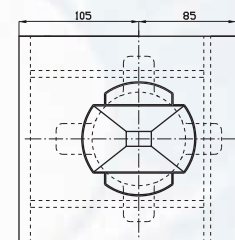

COD. 303.000

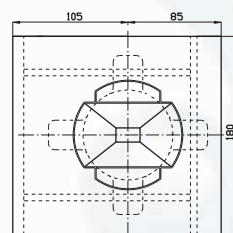

VISTA LATERALE

VISTA FRONTALE

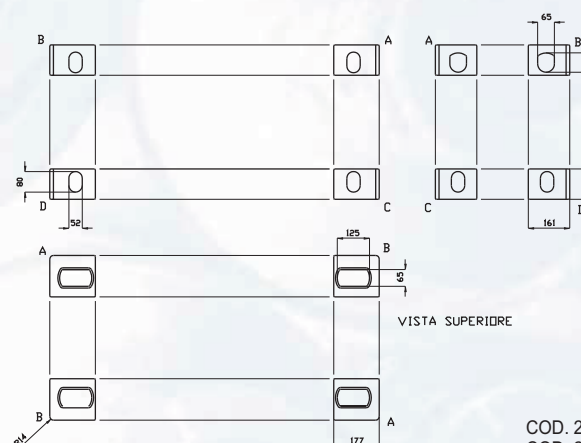

VISTA SUPERIORE

COD. 202.553  
COD. 202.552  
COD. 202.551  
COD. 202.550

Blocco container leggero completo			
<i>Light twist lock</i>			
<b>COD.</b>	303.123	<b>KG.</b>	8,2

Blocco container lungo completo			
<i>Long twist lock</i>			
<b>COD.</b>	303.000	<b>KG.</b>	12

Blocco container corto completo			
<i>Short twist lock</i>			
<b>COD.</b>	202.132	<b>KG.</b>	10,5

Blocco angolo superiore SX			
<i>Upper left corner block</i>			
<b>COD.</b>	202.553	<b>KG.</b>	11,5
<b>LETTERA</b>	A		

Blocco angolo superiore DX			
<i>Upper right corner block</i>			
<b>COD.</b>	202.552	<b>KG.</b>	11,5
<b>LETTERA</b>	B		

Blocco angolo inferiore SX			
<i>Lower left corner block</i>			
<b>COD.</b>	202.551	<b>KG.</b>	11,3
<b>LETTERA</b>	C		

Blocco angolo inferiore DX			
<i>Lower right corner block</i>			
<b>COD.</b>	202.550	<b>KG.</b>	11,3
<b>LETTERA</b>	D		

Magnone doppio finito

*Double carrier*

**COD.** 303.060 **KG.** 4,2

Magnone doppio grezzo

*Rough double carrier*

**COD.** 03.535 **KG.** 4,2

Magnone maschio finito

*Male carrier*

**COD.** 303.061 **KG.** 4,6

Magnone maschio grezzo

*Rough male carrier*

**COD.** 202.058 **KG.** 4,6

Occhione 26 ton

*26 ton towing eye*

**COD.** 07.990 **KG.** 16

Complesso spina per timone  
ø 40 M27 x 2 completa

*Carrier pin kit ø 40 M27 x 2*

**COD.** 303.168 **KG.** 2

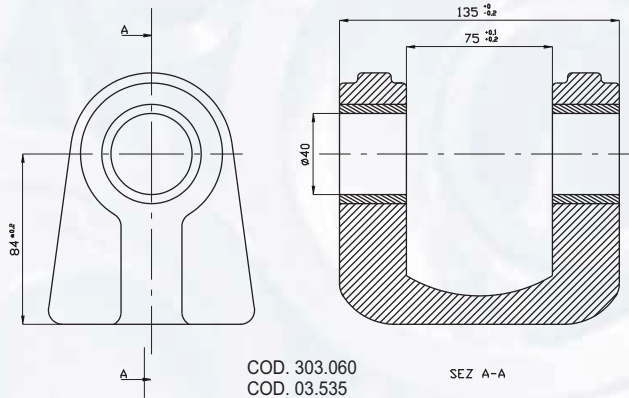

COD. 303.060  
COD. 03.535

SEZ A-A

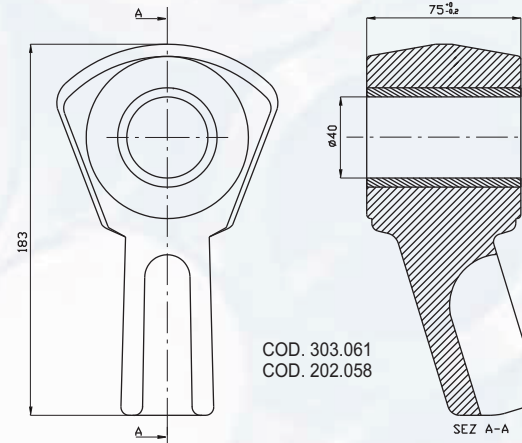

COD. 303.061  
COD. 202.058

SEZ A-A

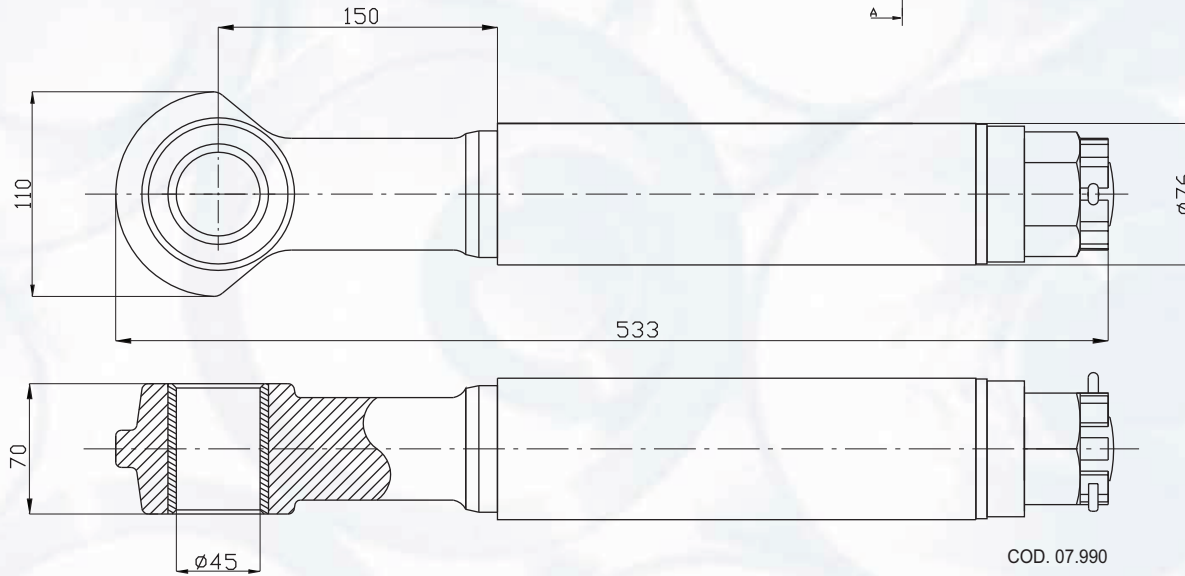

COD. 07.990

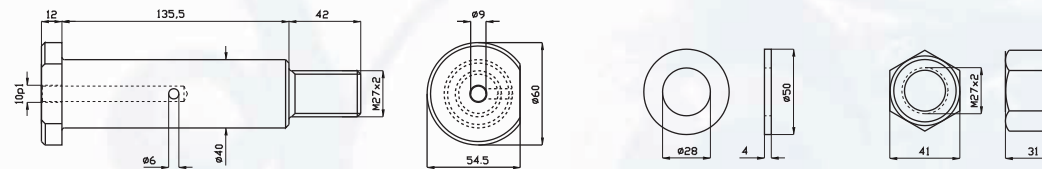

COD. 303.168